

INSTALLATION GUIDE

This installation is applicable for:

- SE-902 Series
- SE-901 Series
- SE-802 Series

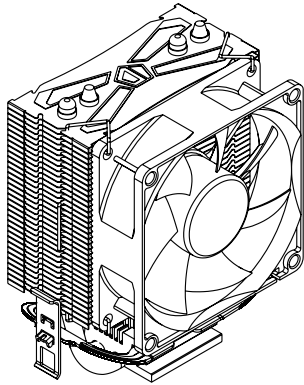

ID COOLING LIMITED
www.idcooling.com

Note: If you have any questions regarding how to install this product, please contact us for support: support@idcooling.com

Accessories

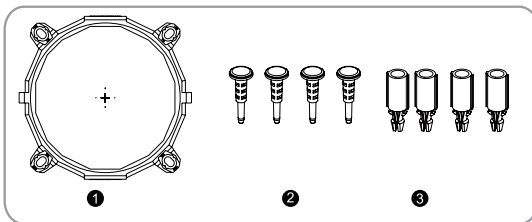

- | | |
|--------------------------|----|
| ❶ Intel Mounting Bracket | x1 |
| ❷ Push-pin Male | x4 |
| ❸ Push-pin Female | x4 |

Intel LGA1156/1155/1150/775

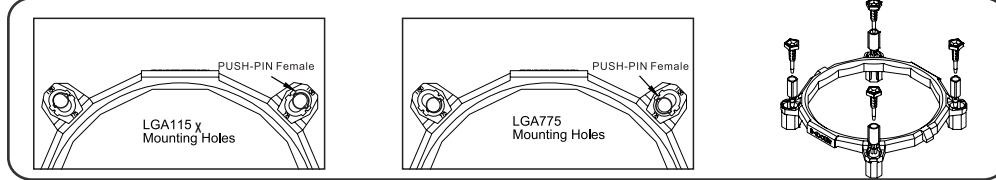

Choose the right mounting holes according to the CPU socket.

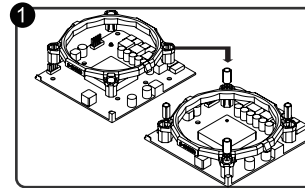

STEP 1
Align the mounting holes of the mounting bracket with the holes of the motherboard; insert the push-pins female through both of the holes.

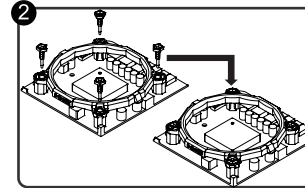

STEP 2
Insert the push-pin male into the female until the mounting bracket is secured onto the motherboard.

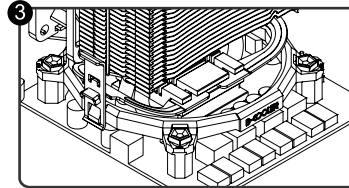

STEP 3
As illustrated, put the heatsink onto the processor and hook the vertical clip onto the tap of the mounting bracket.

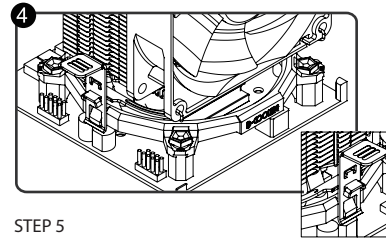

STEP 4
Press down the other side of the metal clip and hook it onto the tab, too. Please make sure the good contact between the heatsink base and the CPU surface during installation.

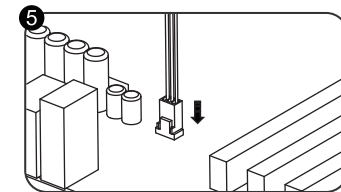

STEP 5
Finish the installation by connecting the fan cable to the motherboard.

AMD FM2+/FM2/FM1/AM3+/AM3/AM2+/AM2

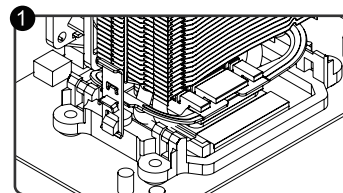

STEP 1
As illustrated, put the heatsink onto the processor and hook the vertical clip onto the tap of the mounting bracket.

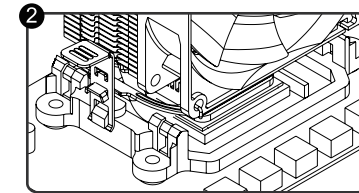

STEP 2
Press down the other side of the metal clip and hook it onto the tab, too. Please make sure the good contact between the heatsink base and the CPU surface during installation.

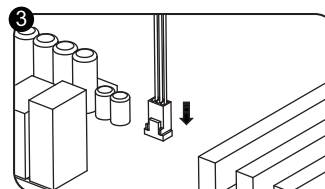

STEP 3
Finish the installation by connecting the fan cable to the motherboard.